



# Wekiva River Basin Commission

November 12, 2021



**WEKIVA PARKWAY**

### Section 6:

- Finish Wekiva River bridges
- Complete final wildlife bridge
- Open multi-use trail
- **Completion: Early 2022**

### Section 7A:

- Local vs. parkway traffic separation complete
- 10-foot-wide sidewalk
- **Open: Mid 2022**

### Section 7B:

- Enhanced traffic flow
- Multi-modal facilities
- **Completion: Early 2022**

### Section 8:

- Completes Central Florida beltway
- **All lanes open: Late 2022**
- **Completion: Early 2023**

## KEY



	Section 4A		Section 4B		Section 7A
	Section 5		Section 6		Section 7B
	Section 4A				Section 8

# What's Next: Overall Landscaping Schedule

Landscaping will take place as separate projects after the major construction is done. Schedule as follows:

- **Section 6: Spring 2022**
  - **Section 7A: Fall 2022**
  - **Section 7B: Fall 2022**
  - **Section 8: Late 2023**
- **Ensuring landscaping quality and viability:** FDOT requires contractors maintain plants during a two-year warranty period after final installation
  - **Long-term maintenance:** FDOT asset management contract includes mowing, litter and weed control



# Roundabout Construction

WEKIWA PARKWAY



## Stockpiled Limestone Rocks



# Roundabout Aesthetics – Community Engagement

WEKIVA PARKWAY

FDOT received community feedback regarding the roundabout aesthetics and the impact on wildlife.

**Listening sessions:** FDOT embarked on a listening tour

- Reached out to 50 key stakeholders on Sections 6 & 7A
- Conducted 16 listening sessions – virtual and in person
- Goals:
  - Share project information and constraints
  - Receive input to help enhance the roundabout aesthetics plan

The department committed to listening to public concerns and meeting the community's vision for the area.

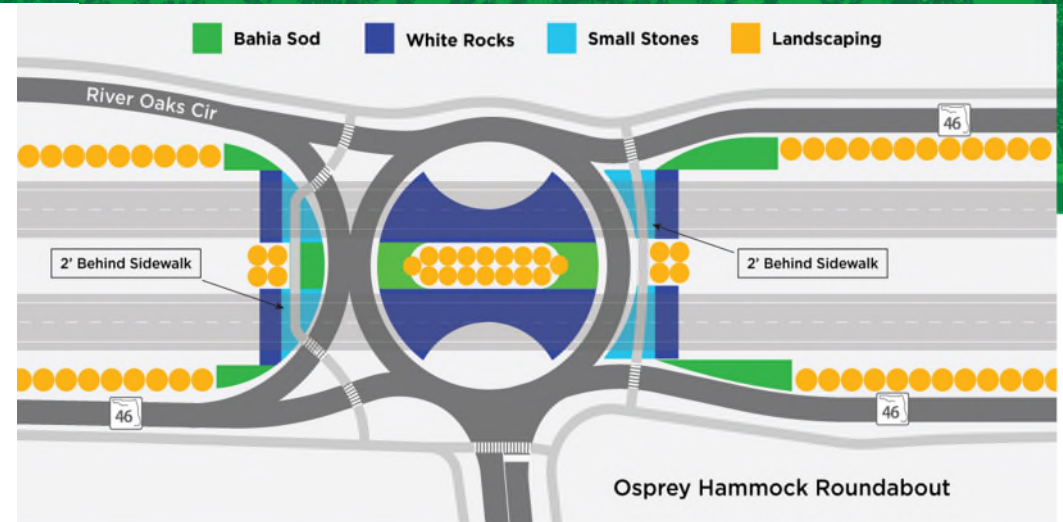

# Key Stakeholders Submitting Input

**WEKIVA PARKWAY**

**Bear Warriors**

**Estates of Wekiva Park HOA**

**Florida Department of Environmental Protection -  
Wekiva River Basin State Parks**

**Florida Fish & Wildlife Conservation Commission**

**Florida Native Plants Society**

**Friends of Wekiva River**

**LaFleur Nursery**

**Lake Forest HOA**

**Markham Forest HOA**

**Seminole County Commissioner Andria Herr, District 5**

**Seminole County Leisure Services – Greenways &  
Natural Lands Division**

**Seminole County Public Works**

**St. Johns Riverkeepers**

**Sustainability Leaders Initiative**

**The Rock Church**

**UF / IFAS Extension, Florida Friendly Landscaping  
(Seminole County & State Offices)**

**Wekiva Park Drive Neighborhood**

**Wekiva River Basin Commission (including Seminole  
County Commission Chairman Lee Constantine)**

**Wekiva River Oaks HOA**

# Community Meeting – October 21

WEKIWA PARKWAY

**Community meeting:** Shared what we heard, and get further input from the larger community

**Attendance: 38 participants** (25 public, 13 staff)

- In-person, virtual and phone

## Seminole County Officials:

Jean Jreij, Public Works Director

Bill Pandos, Leisure Services – Greenways and Natural Lands Division

Tony Nelson, Public Works

## Comments Received:

- **Comment Forms: 7**
- **Virtual Questions / Comments: 3**
- **Poll: 332 participants**
- **Emails: 20**



# What We Heard: Roundabout Aesthetics

## Comment Categories

- Visual appearance
- Wildlife impacts
- Maintenance
- Deterrent to mischief / unintended activity
- Vegetation / plants
- Erosion / drainage

Visual Appearance	
Favorable	Unfavorable
Like the look, decorative, aesthetic	Don't like the look, hostile architecture, rocky barren, too prominent
Fits with the rocks we have in our entrance	Doesn't fit the environment
Will go well with plants, other materials when completed	Was expecting or would rather see plants

**Requests:** Leave all the rocks as planned, remove some of the rocks and remove all the rocks



# What We Heard: Wildlife Comments

- Florida Fish & Wildlife Conservation Commission
- Florida Department of Environmental Protection - Wekiva River Basin State Parks
- Seminole County Leisure Services – Greenways & Natural Lands Division
- Friends of Wekiva River
- St. Johns Riverkeepers
- Bear Warriors
- Sustainability Leaders Initiative

**Requests:** Remove at least a 5-foot swath of rocks next to the bridge wall to provide additional area for animals to cross

Wildlife Comments	
Favorable	Unfavorable
Bears, deer, otter, etc., can climb over rocks	Rocks could push wildlife into road
Animals savvy enough to go around obstacles, can use sidewalk / animals climb over things all the time in the wild	Gopher tortoises, snakes, other small animals may find large rocks hard to navigate
Large rocks provide cover for snakes and small animals from predators	Rocks may harbor snakes

# Discussions: Roundabout Aesthetic Ideas

WEKIVA PARKWAY

FDOT explored various aesthetic components for the Wekiva Parkway roundabouts with community members and environmental stakeholders.

- Stone variations
- Other material
- Hardscaping
- Native, shade-tolerant plants



## Common Themes

- Look natural
- Stable, less susceptible to erosion/washout
- Easily traversable by wildlife
- Native to area
- Least costly – concern for taxpayer dollars
- Readily / easily available
- Durable
- Lowest / easiest maintenance (less labor intensive)
- No to impervious surfaces – want to promote aquifer recharge
- Be mindful of calcium and pH balance effect of materials

# Results of Community Engagement

WEKIVA PARKWAY

## DESIGN CONCEPTS

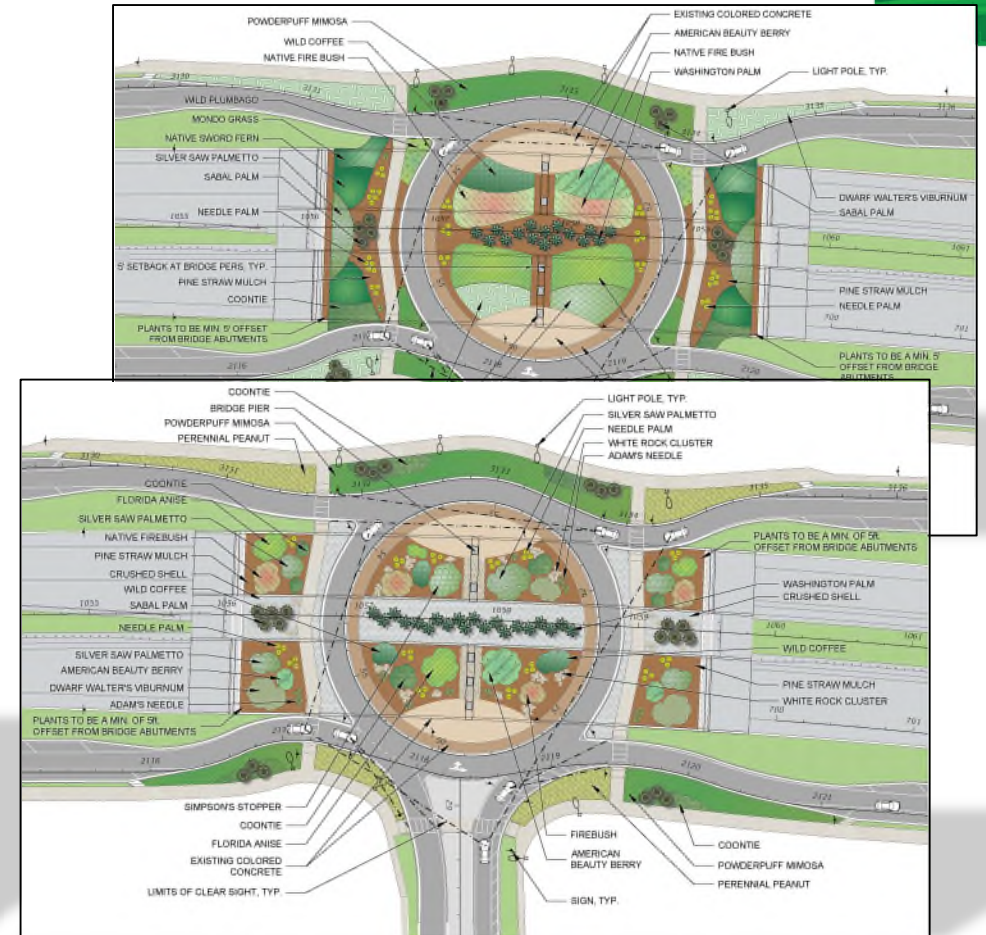

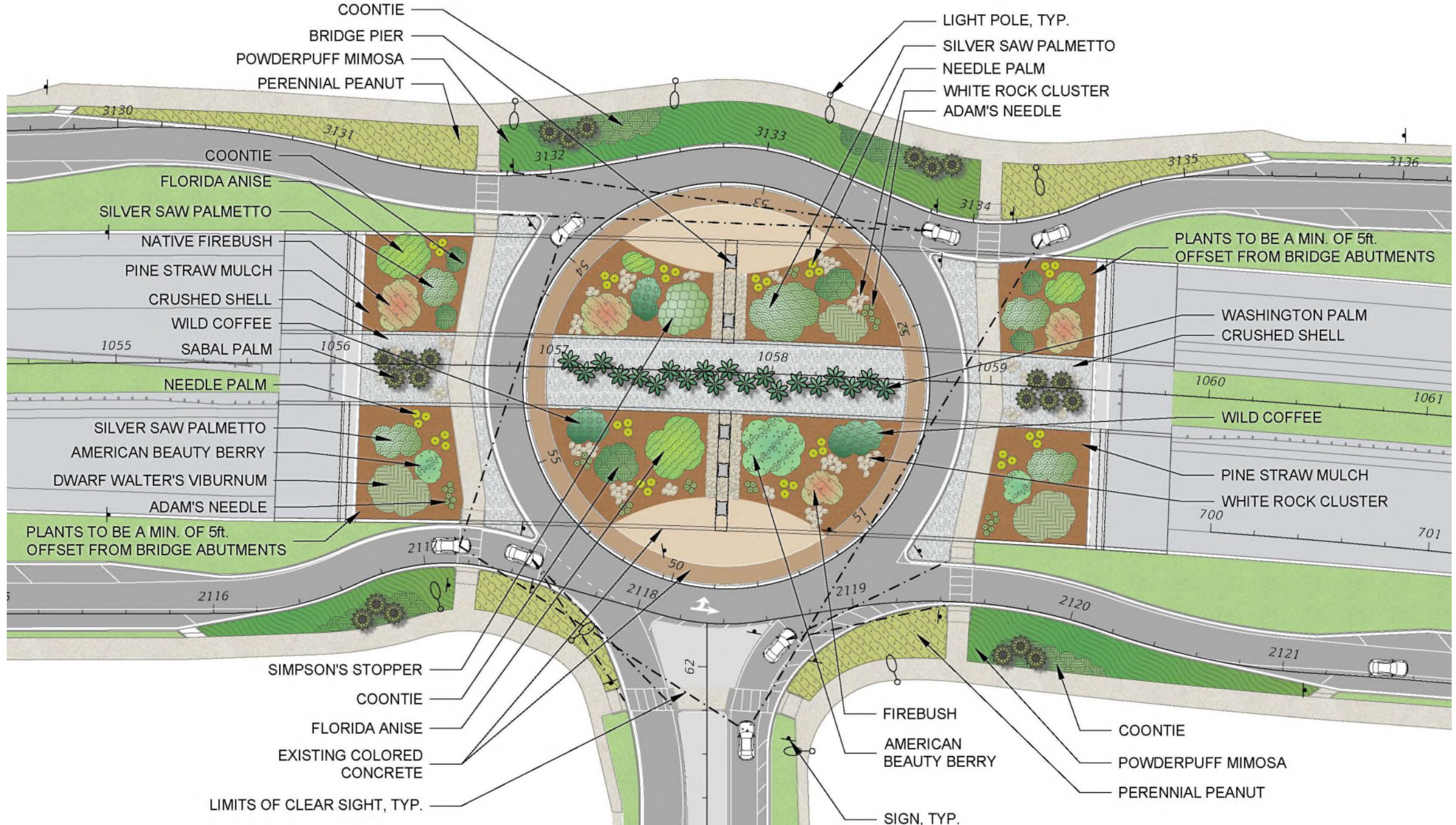

# REDUCED ROCK OPTION



**REDUCED ROCK OPTION**

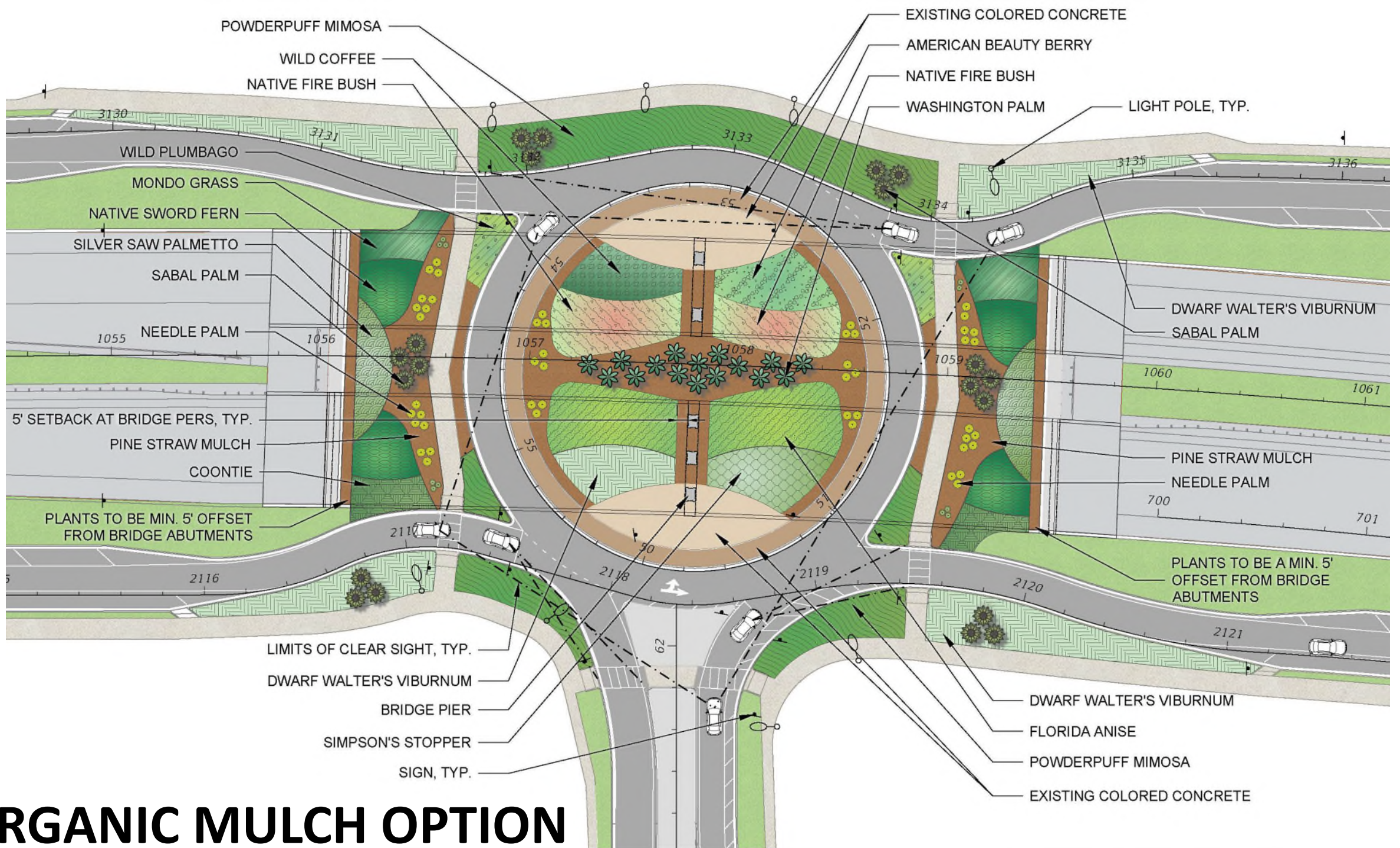

# ORGANIC MULCH OPTION



**ORGANIC MULCH OPTION**



**ENHANCED DESIGN OPTIONS**

**WEKIWA PARKWAY**

# **DESIGN CONCEPTS**

**REDUCED ROCK**

**ORGANIC MULCH**





## For more information contact

- **Website:** [www.wekivaparkway.com](http://www.wekivaparkway.com)
- **Email:** [info@wekivaparkway.com](mailto:info@wekivaparkway.com)
- **Project Hotline:** 407-710-5610
- **Social Media:**

 [FB.com/WekivaParkway](https://www.facebook.com/WekivaParkway)

 [@WekivaPKWYInfo](https://twitter.com/WekivaPKWYInfo)